



Architectural Enhancement: Aesthetical Design With Concrete Masonry

NCMA

AIA/CES Course #: 000530

Continuing
Education
System





Continuing
Education
System

The *National Concrete Masonry Association* is a Registered Provider with *The American Institute of Architects Continuing Education Systems (AIA/CES)*. Credit(s) earned on completion of this program will be reported to *AIA/CES* for AIA members. Certificates of Completion for both AIA members and non-AIA members are available upon request.

This program is registered with *AIA/CES* for continuing professional education. As such, it does not include content that may be deemed or construed to be an approval or endorsement by the AIA of any material of construction or any method or manner of handling, using, distributing, or dealing in any material or product.

Questions related to specific materials, methods, and services will be addressed at the conclusion of this presentation.



Learning Objectives

Continuing
Education
System

At the end of this program, participants will know:

- Proper application of aesthetic design measures into concrete masonry wall systems
- Features of recent award winning projects
- Sustainable attributes of concrete masonry
- Specifications, tolerances and other requirements for concrete masonry construction



Design Awards

Continuing
Education
System

Those projects which receive a design award are deemed superior to other projects by your peers.

Award-winning Concrete Masonry Projects appear in the eyes of the Judicial Team better than all others in their respective category.

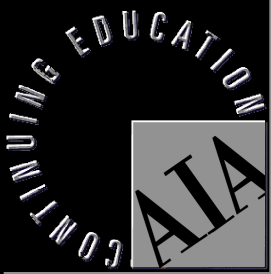

Concrete Masonry



DESIGNS

Continuing
Education
System

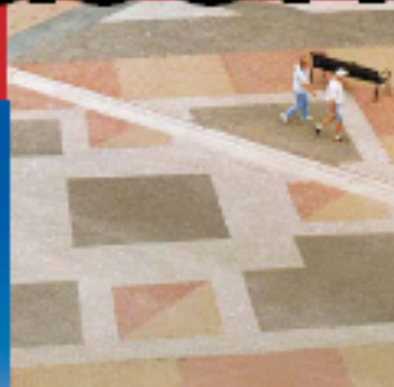

2002 NCMA
DESIGN AWARDS
OF EXCELLENCE

College

Continuing
Education
System



Business District and College Link Streetscape

Continuing
Education
System



Gray Block and Sunlight

Continuing
Education
System

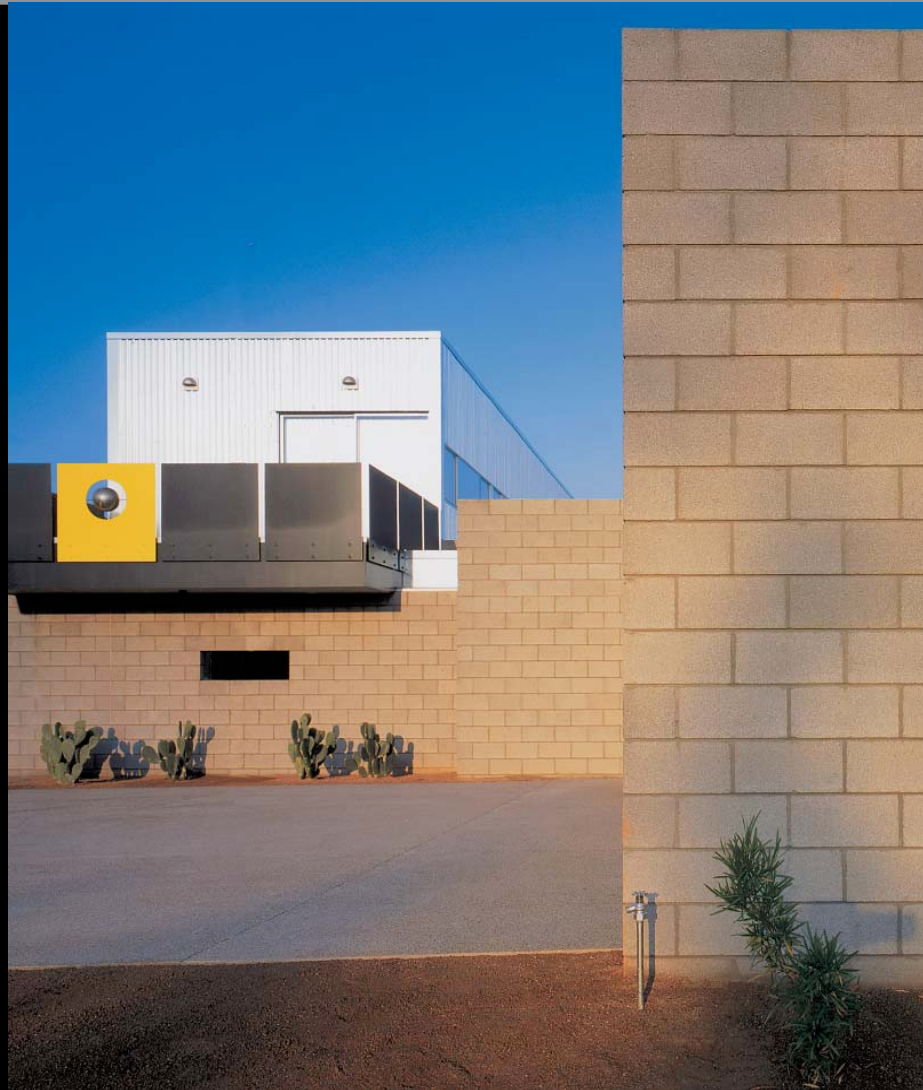

Stunning Visual Effect

Continuing
Education
System



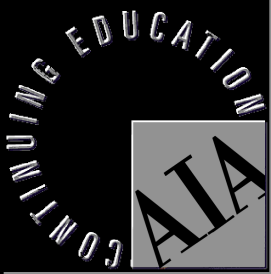

Concrete Masonry



DESIGNS



2003 NCMA
DESIGN AWARDS
OF EXCELLENCE



Continuing
Education
System





LEED Certified

Continuing
Education
System





Community College, LEED Certified

Continuing
Education
System



Inspiration

Continuing
Education
System



Training Facility

Continuing
Education
System



Training Facility

Continuing
Education
System



Residential Strategy

Continuing
Education
System



Inventive Architecture

Continuing
Education
System



Inventive Architecture

Continuing
Education
System



Hillside Dream Home

Continuing
Education
System



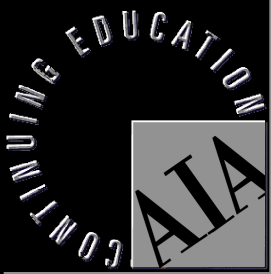

Hillside Dream Home

Continuing
Education
System



Landscape Excellence

Continuing
Education
System



Landscape Excellence

Continuing
Education
System





Clients and Aesthetics

Continuing
Education
System

A common dilemma faced by the Architectural Community is a Client's changing expectations and response relative to the project's appearance over time and under varying conditions.

There are references to model building codes and specifications which can assist in laying the ground rules applicable to all parties.

They assume an understanding and application of the techniques unique to the nature of Masonry by all parties.



Masonry and the Bottom Line

Continuing
Education
System

Concrete Masonry continues to be cost-competitive to within approximately +/- 5% of other construction materials and methods.

Architectural Concrete Masonry Units

TEK 2-3A

Continuing
Education
System



(a) Split Face and Glazed



(b) Fluted Split Face

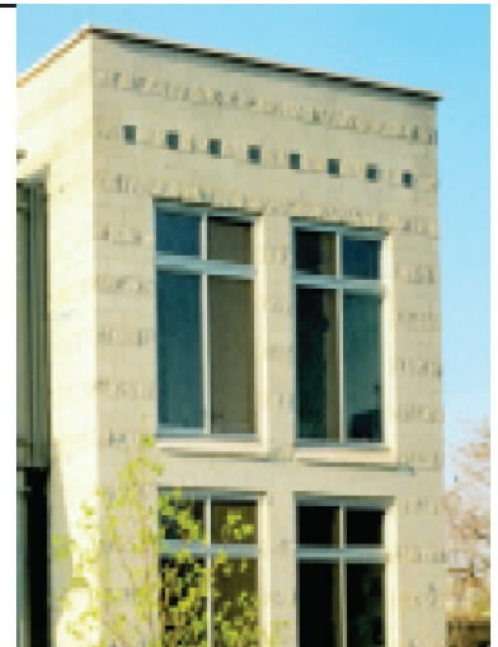

(c) Split and Ground Face

Figure 1—Examples of Architectural Concrete Masonry Units

Architectural Concrete Masonry Units

TEK 2-3A

Continuing
Education
System

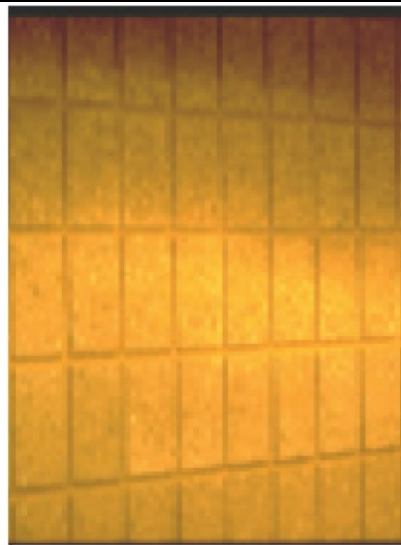

(a) Scored and Ground Face



(b) Glazed



(c) Slump Block

Figure 2—Additional Examples of Architectural Concrete Masonry Units

Architectural Concrete Masonry Units

Continuing
Education
System



Sand and Gravel Deposit

Continuing
Education
System



Sand and Gravel Operation

Continuing
Education
System



Specifying Concrete Masonry Units

Continuing
Education
System

- Included in C 90
 - Compressive Strength
 - Absorption
 - Dimensional Tolerances
 - Density Definitions
 - Linear Drying Shrinkage



C 90

Standard Specification for
Loadbearing Concrete
Masonry Units

Specifying Concrete Masonry Units

Continuing
Education
System

- **NOT** Included in C 90
 - Color
 - Texture
 - Density
 - Water Repellency
 - Fire Ratings
 - Thermal Properties
 - Sound Properties

Most architectural concrete masonry units are custom made. Work closely with producers to get exactly what you want.



C 90

Standard Specification for
Loadbearing Concrete
Masonry Units

TEK 1-1C



Specifying Concrete Masonry Units

Continuing
Education
System

ASTM C 90 includes:

Permissible Variations in Dimensions

Standard Units.

Particular Feature Units.

Exposed Surfaces; Finish and Appearance Observational Conditions

When viewed from a distance of not less than 20 feet under diffused lighting.

Approved sample using not less than four units representing range of color and texture.

Color and texture need be specified.

Compliance allowances

Stucco Covering

Continuing
Education
System



Award-Winning Veneer

Continuing
Education
System



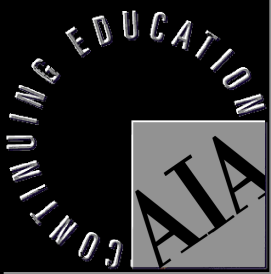

Specifying Concrete Masonry Construction Natural Color Variations of Gray Block

DESIGN GRAPHICS

Continuing
Education
System

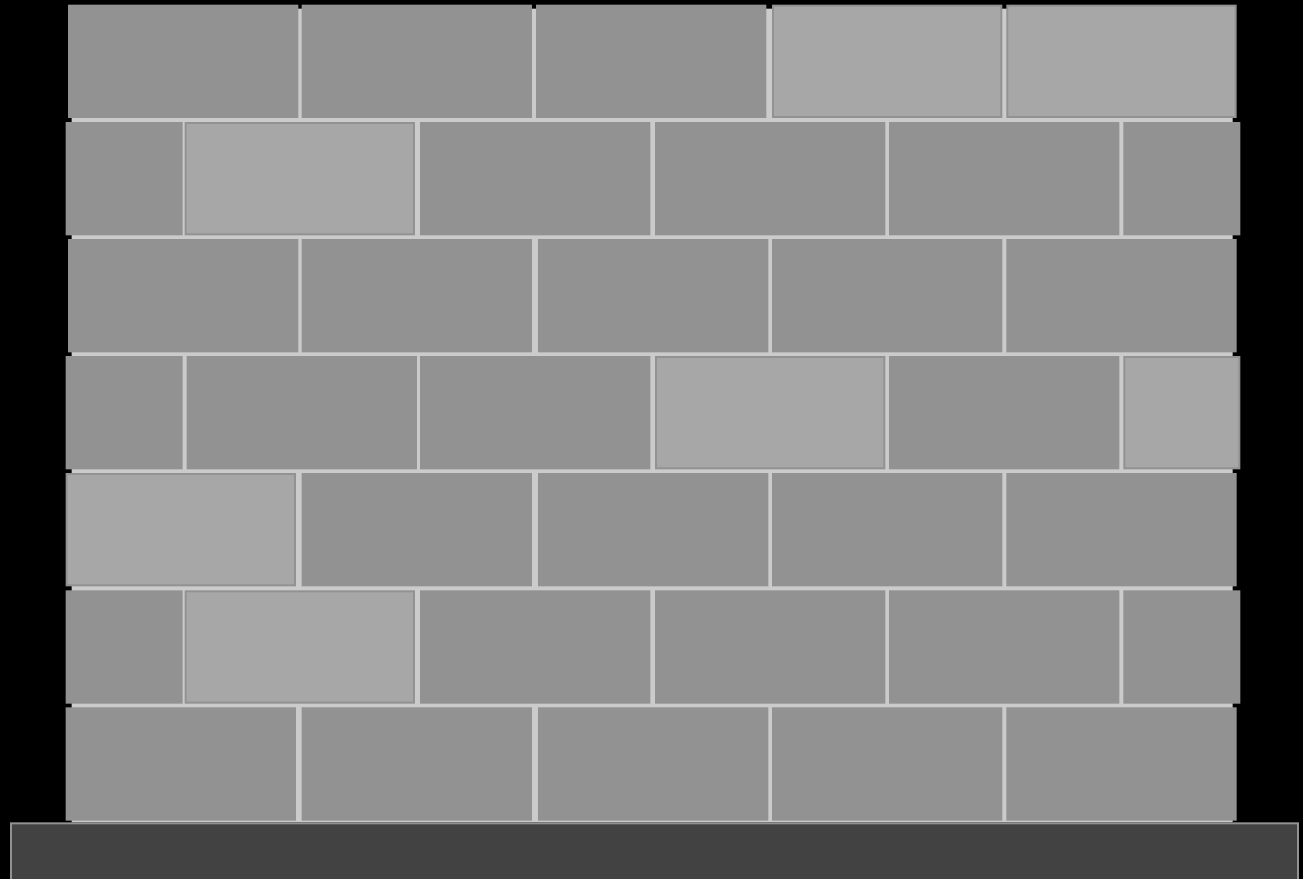

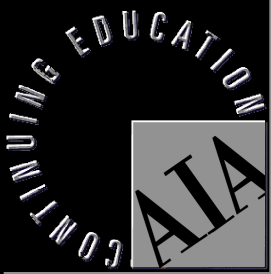

Specifying Concrete Masonry Construction

DESIGN GRAPHICS

Continuing
Education
System

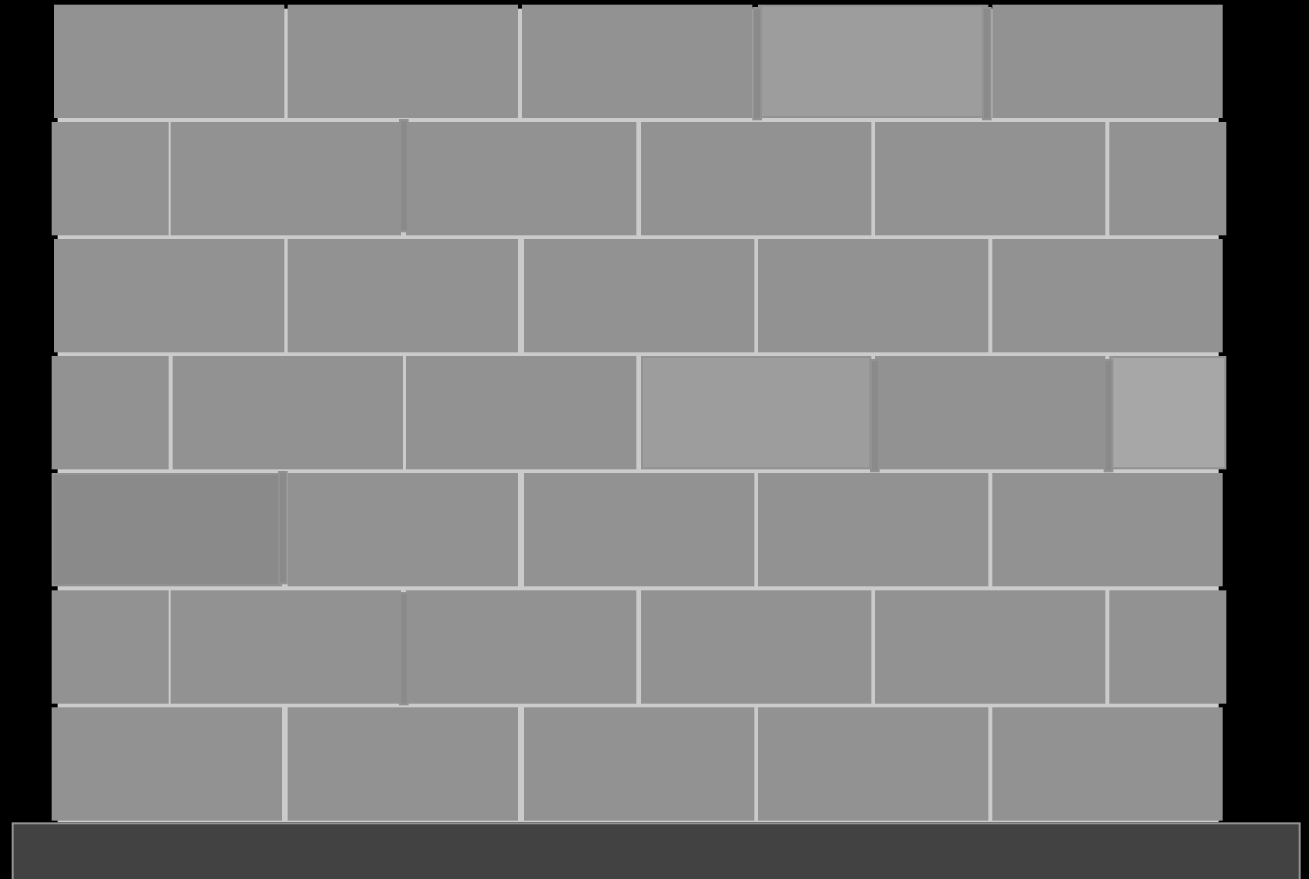

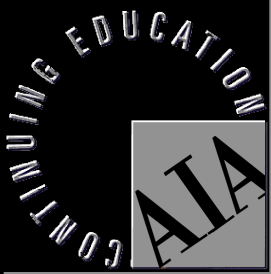

Specifying Concrete Masonry Construction

DESIGN GRAPHICS

Continuing
Education
System

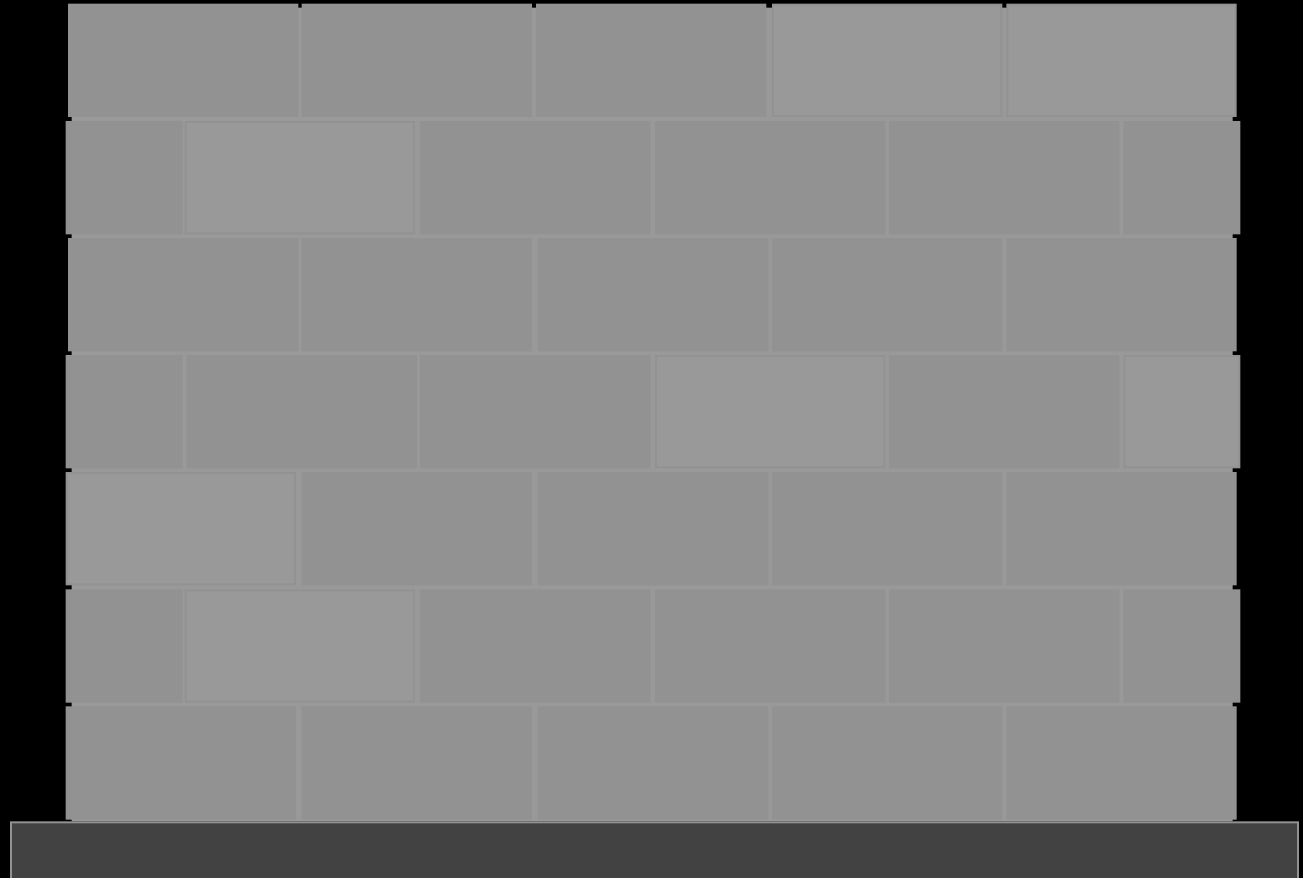



Specifying Concrete Masonry Construction

DESIGN GRAPHICS

Continuing
Education
System

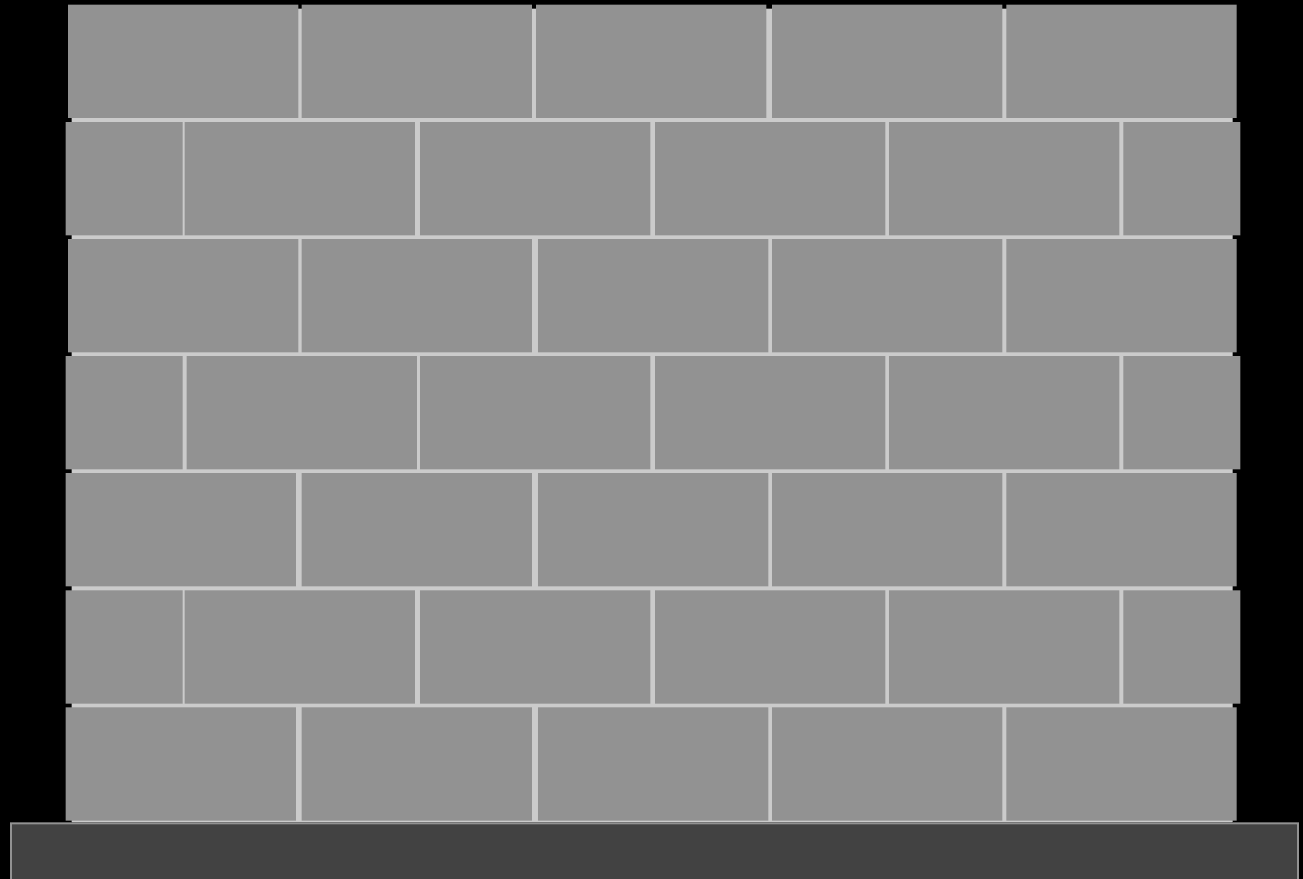



Products & Workmanship

Tying it all Together

Continuing
Education
System

- **The quality and compatibility of material components and care in installation are key to wall performance.**
- **The recommended specification for products and workmanship for masonry construction are covered in the applicable edition of Masonry Standards Joint Committee ACI 530.1/ ASCE 6/ TMS 602 (“MSJC”)**

Reported by the Masonry Standards Joint Committee

Building Code Requirements for Masonry Structures
(ACI 530-02/ASCE 5-02/TMS 402-02)

Specification for Masonry Structures
(ACI 530.1-02/ASCE 6-02/TMS 602-02)

Commentary on
Building Code Requirements for Masonry Structures
(ACI 530-02/ASCE 5-02/TMS 402-02)

Commentary on
Specification for Masonry Structures
(ACI 530.1-02/ASCE 6-02/TMS 602-02)





Tolerances of Concrete Masonry Construction

Continuing
Education
System

MSJC tolerances are structurally-based yet affect aesthetics:

Dimension of Elements

Variations of Elements

Locations of Elements



Tolerances of Concrete Masonry Construction

DESIGN GRAPHICS

Continuing
Education
System

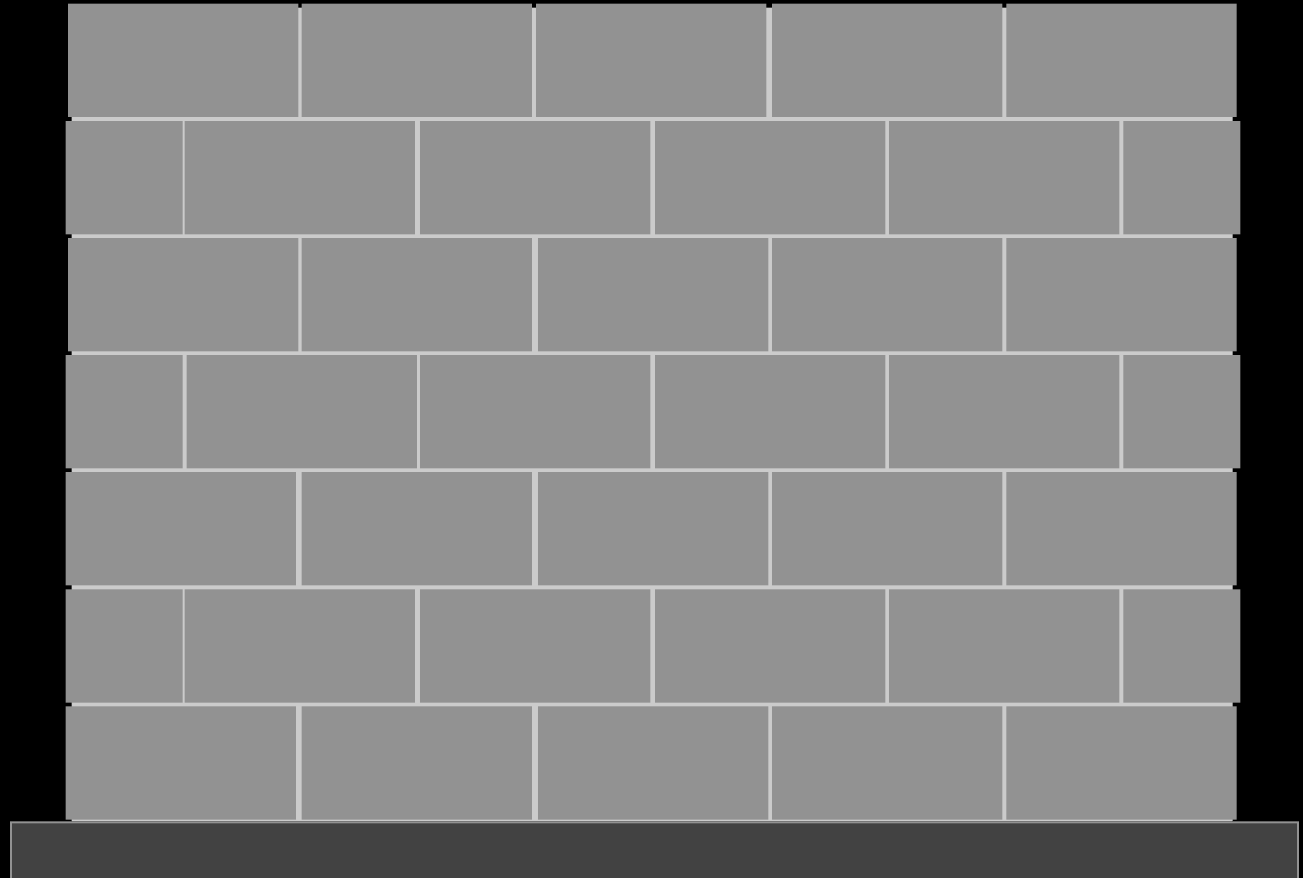



Tolerances of Concrete Masonry Construction

DESIGN GRAPHICS

Continuing
Education
System

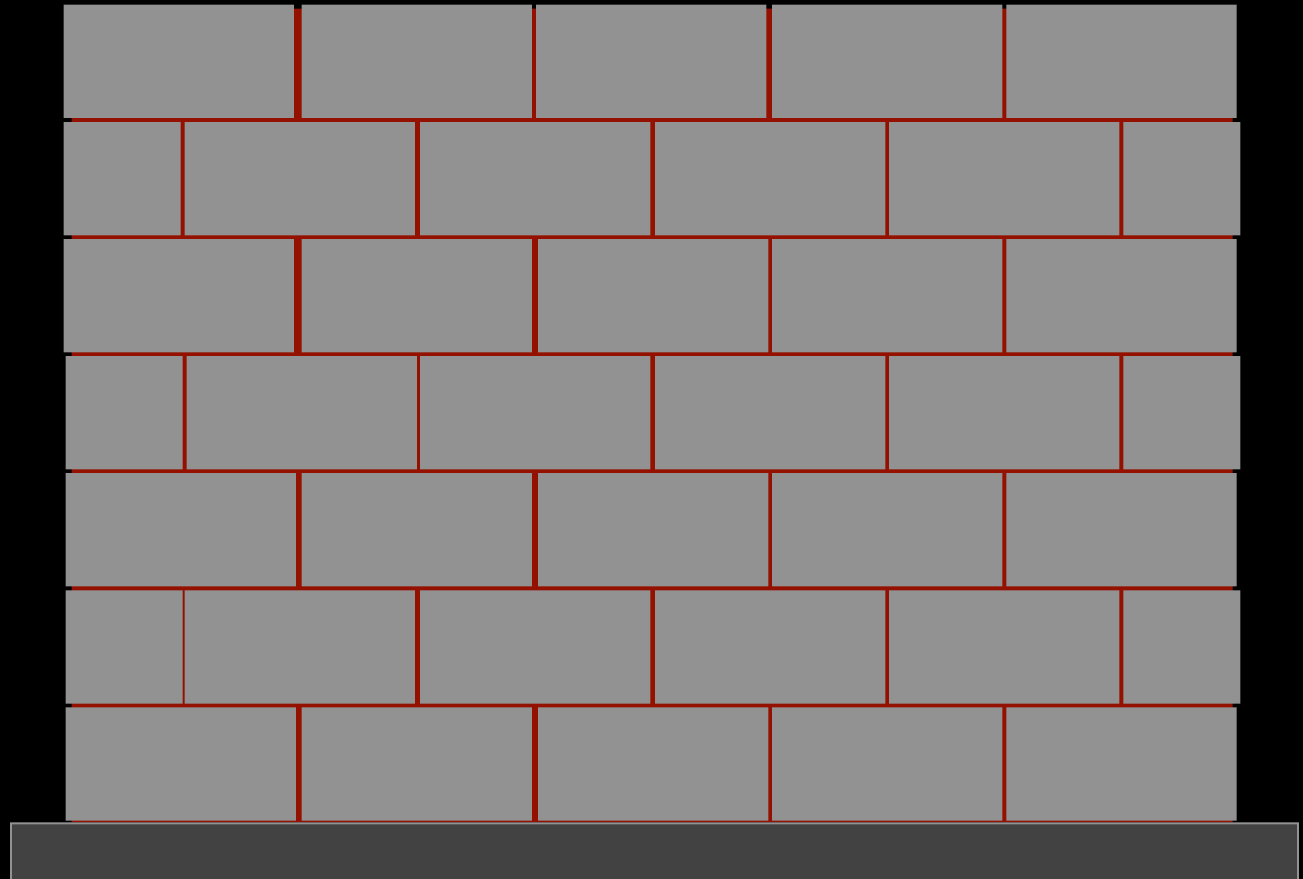

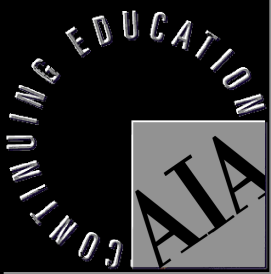

Tolerances of Concrete Masonry Construction

DESIGN GRAPHICS

Continuing
Education
System

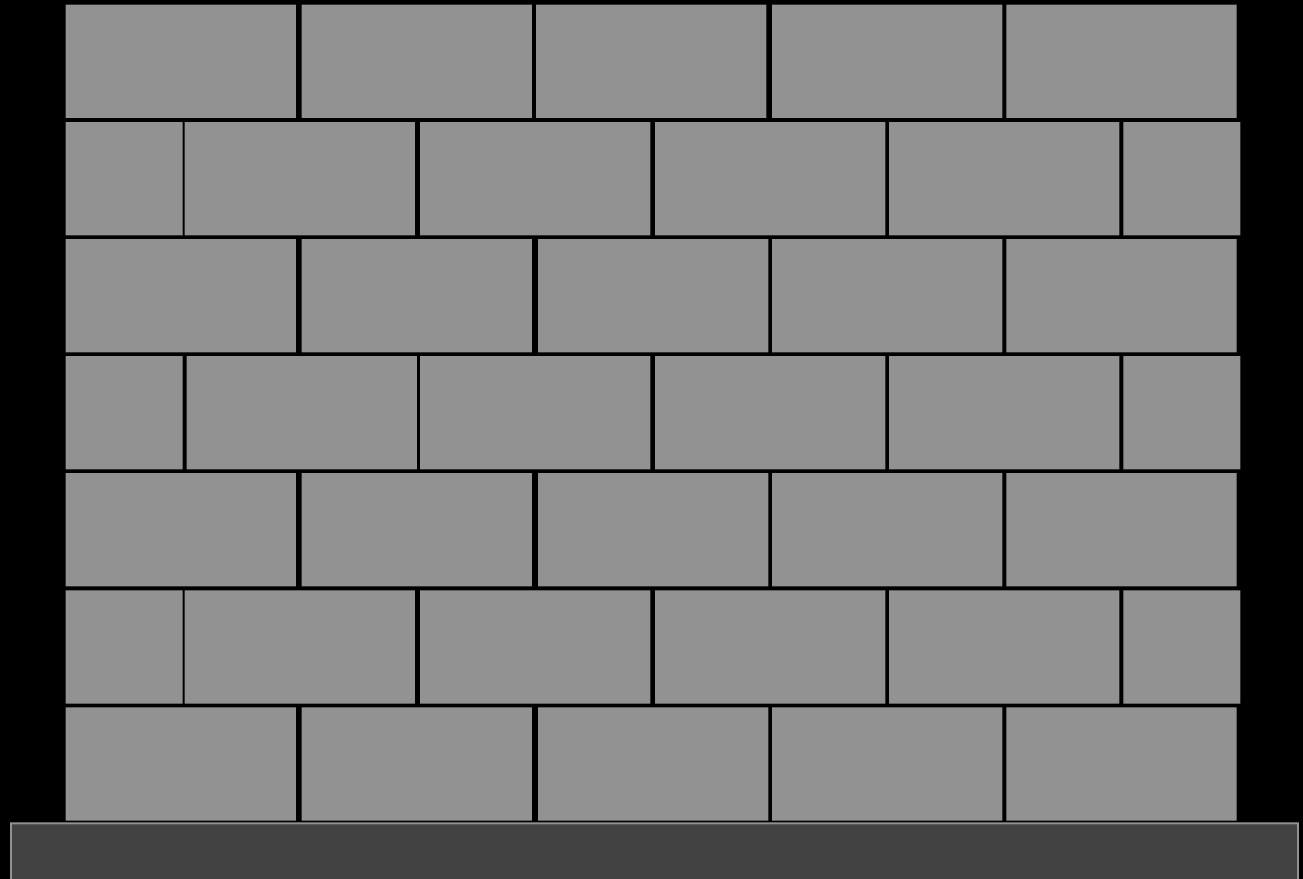



Specifying Concrete Masonry Construction

DESIGN GRAPHICS

Continuing
Education
System

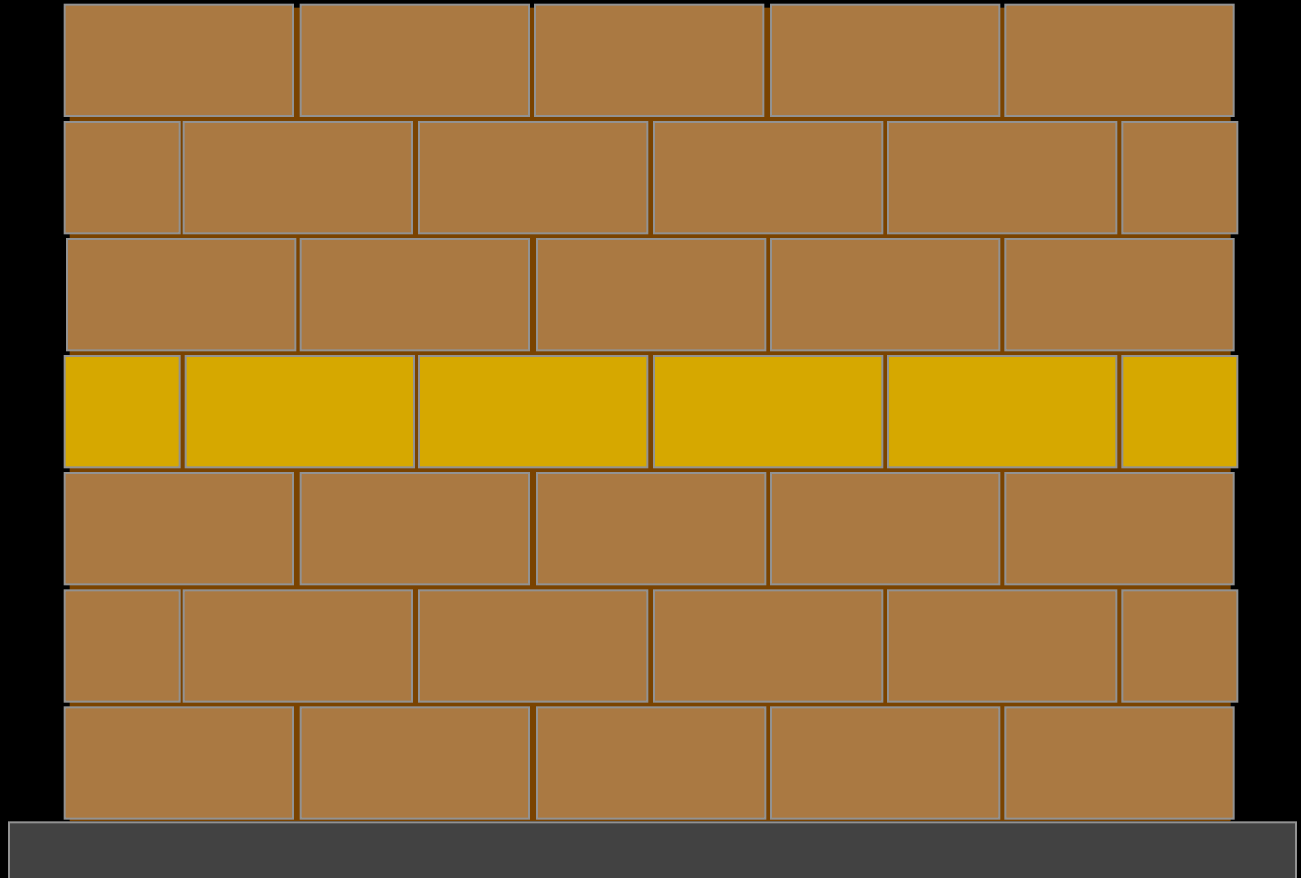

Block Color Banding with Mortar Shading

Continuing
Education
System



More Banding With Texture

Continuing
Education
System



CMU Band in Clay Brick Veneer

Joint reinforcement w/ no slip plane

Continuing
Education
System

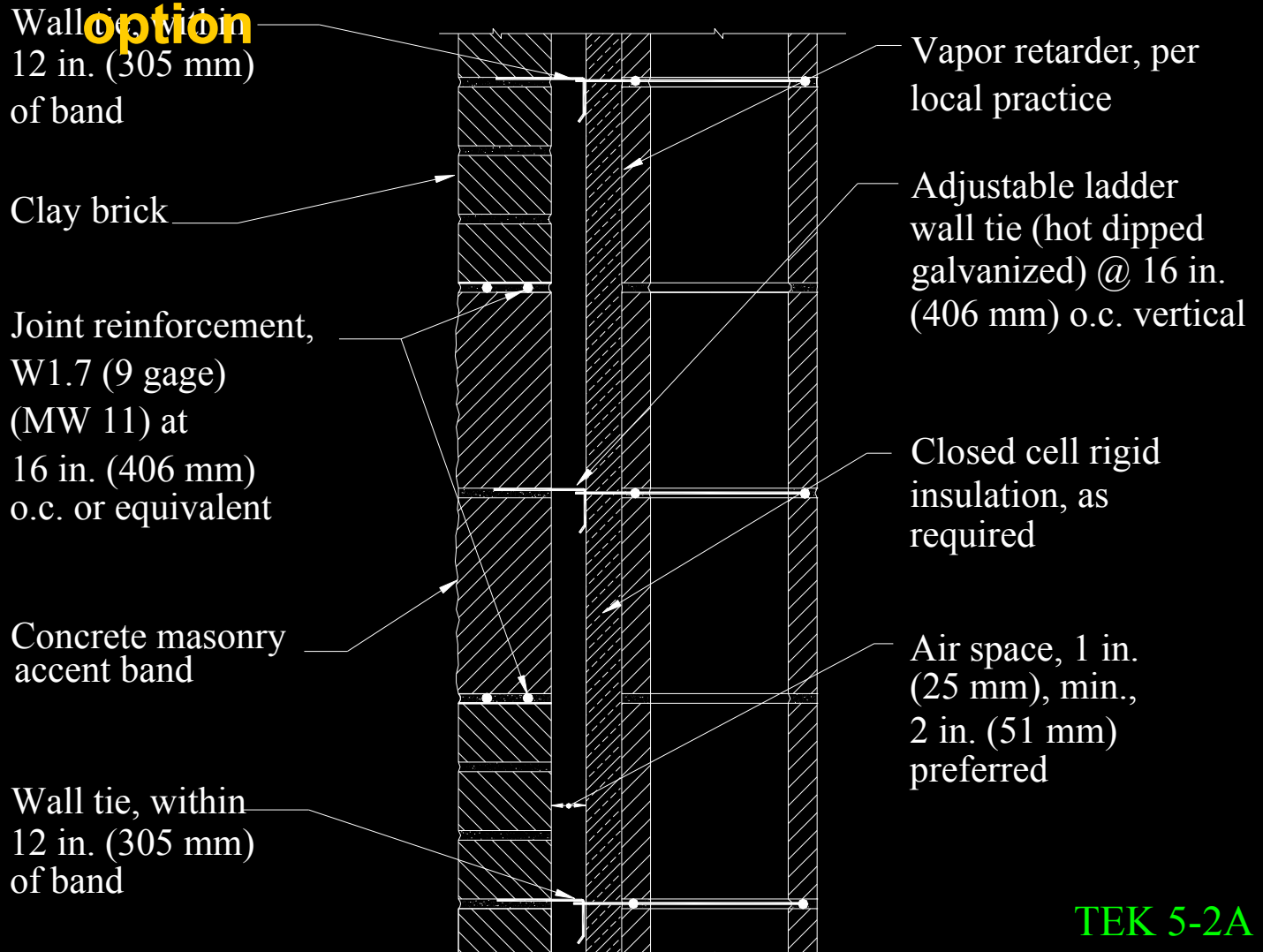

Construction of High Rise Concrete Masonry Buildings

Continuing
Education
System



TEK 3-12



Low-Rise Construction

TEK 3-13

Continuing
Education
System



Low-Rise Construction

TEK 3-13

Continuing
Education
System

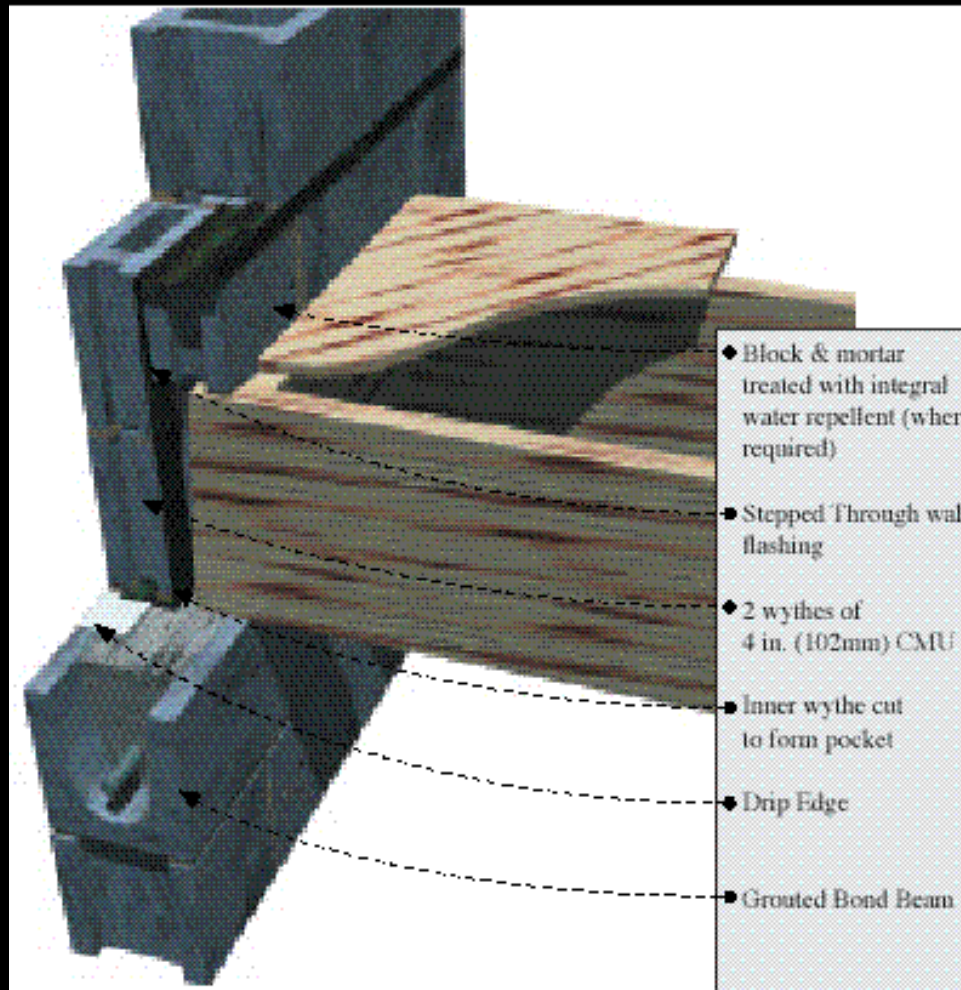

Figure 4—Beam Pocket Bearing Detail

Low-Rise Construction

TEK 3-13

Continuing
Education
System

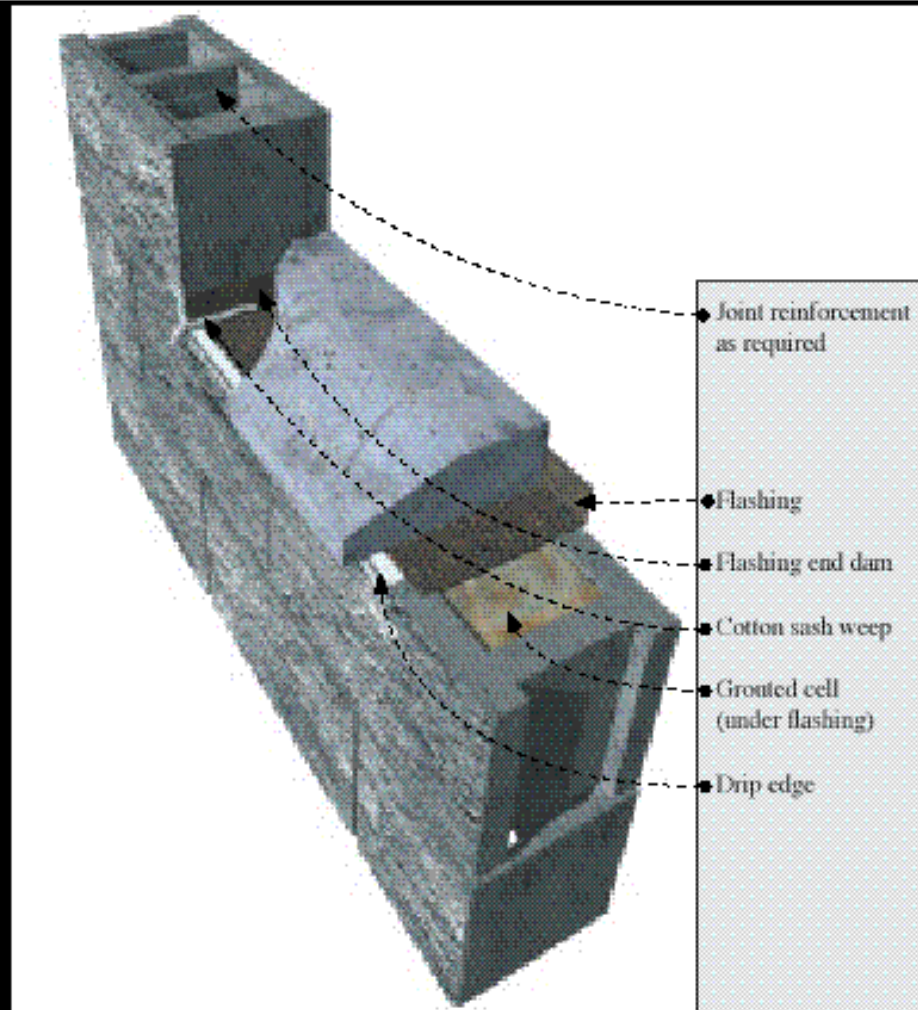
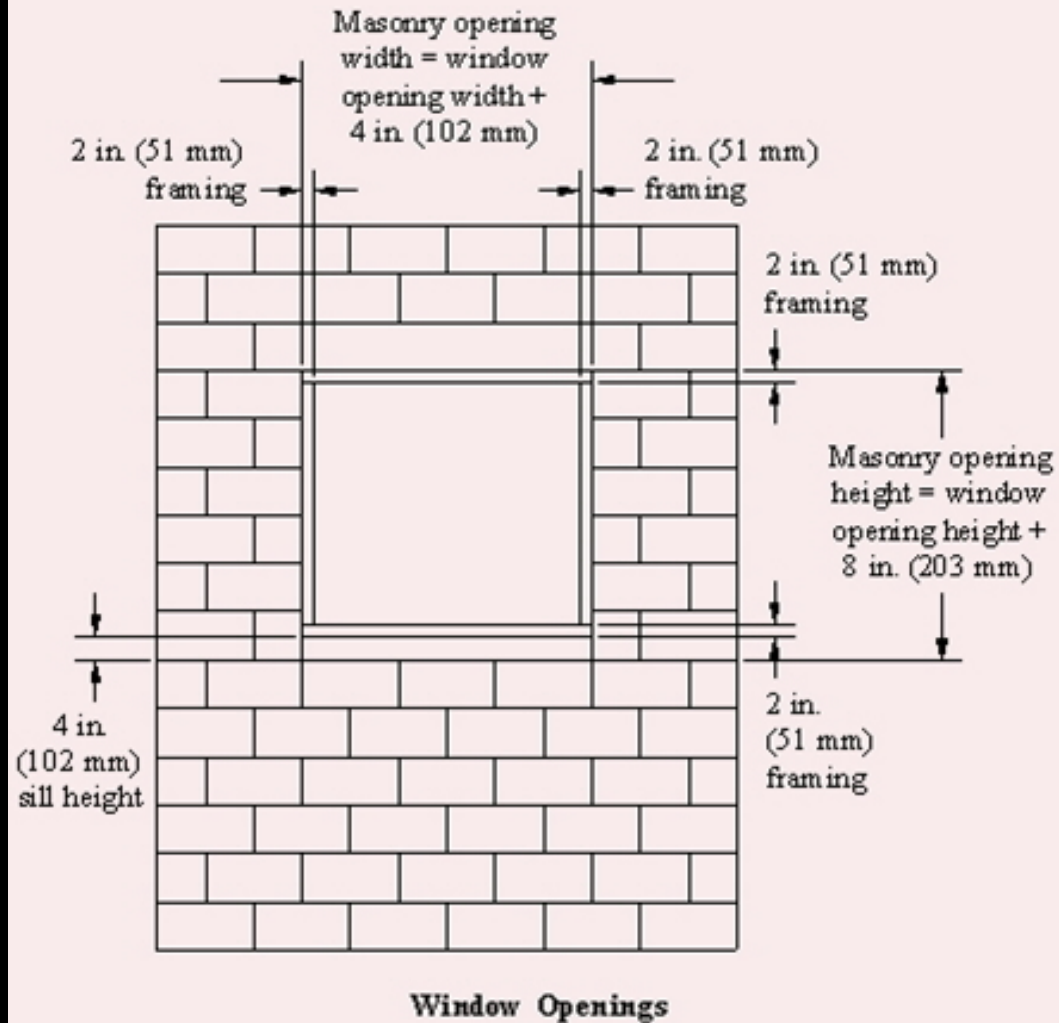

Figure 9—Window Sill Detail

Productivity and Modular Coordination

TEK 4-1A

Continuing
Education
System



Productivity and Modular Coordination

TEK 4-1A

Continuing
Education
System

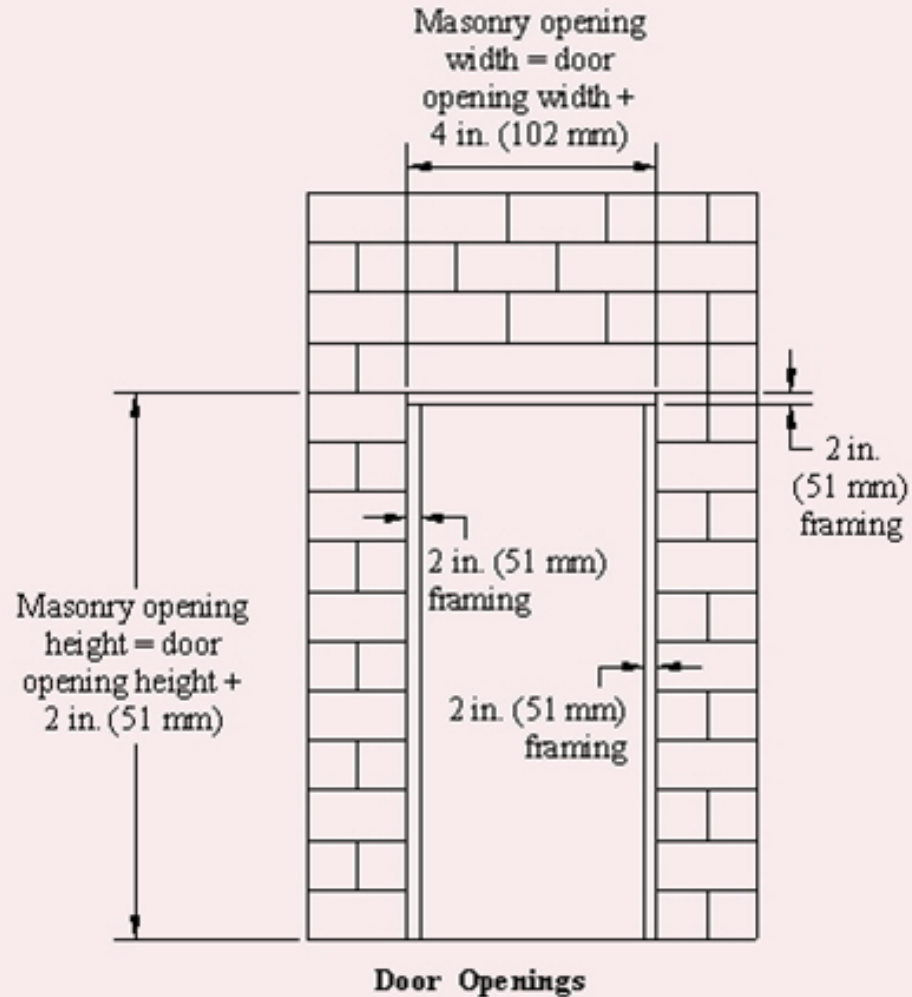

Figure 2—Modular Wall Openings

Integrating Concrete Masonry Walls with Metal Buildings

TEK 5-5A

Continuing
Education
System

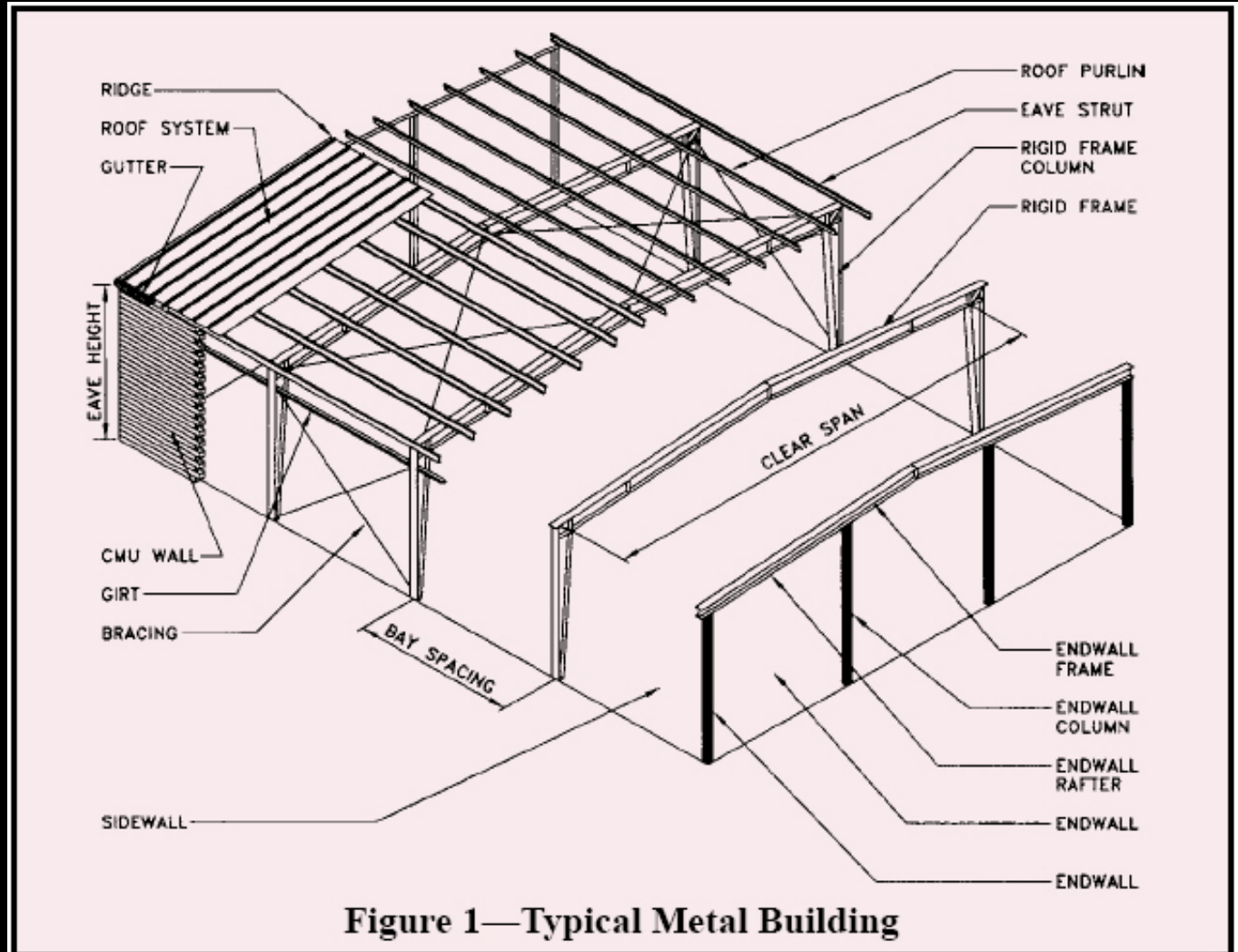

Figure 1—Typical Metal Building

Integrating Concrete Masonry Walls with Metal Buildings

TEK 5-5A

Continuing
Education
System

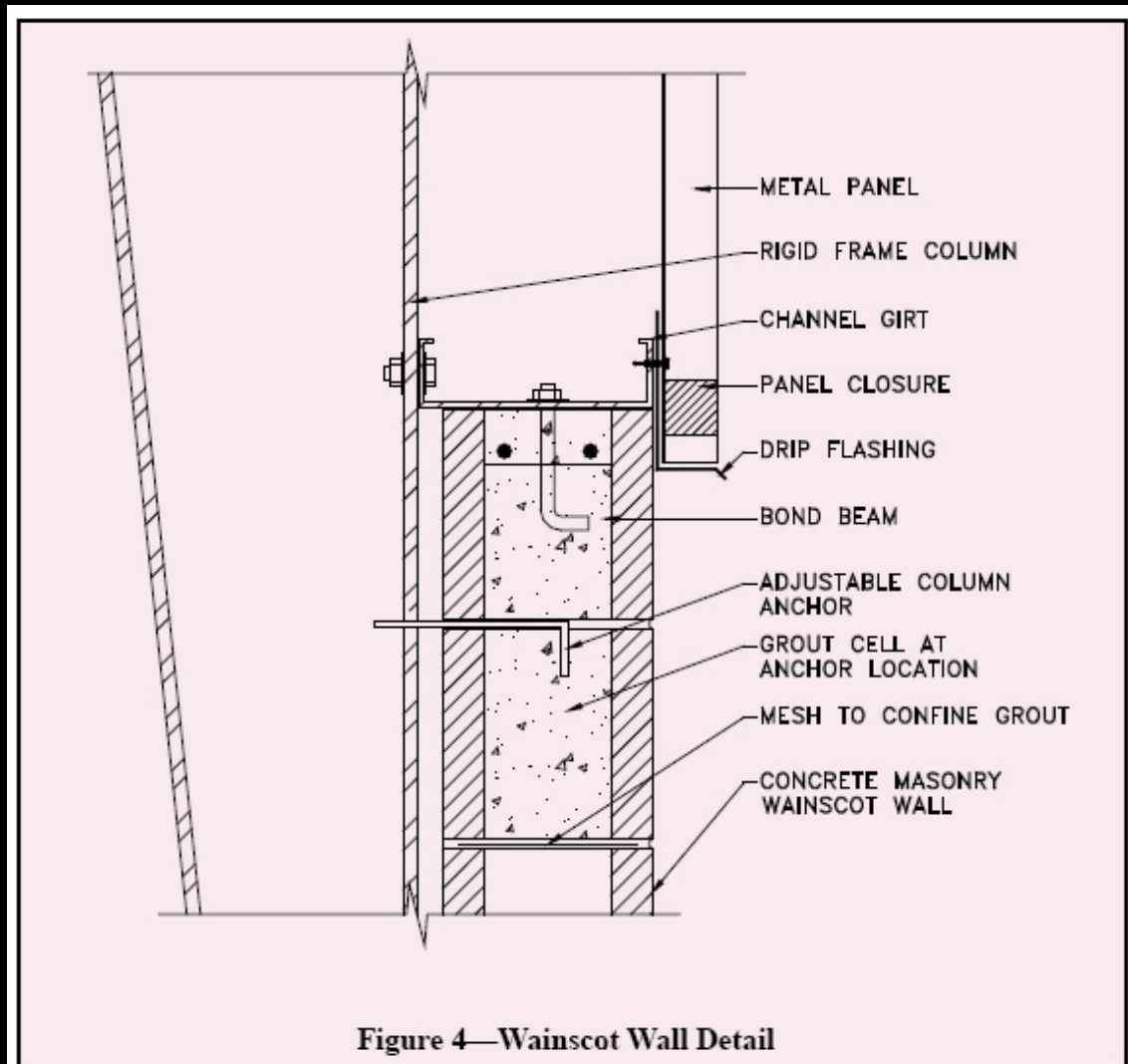
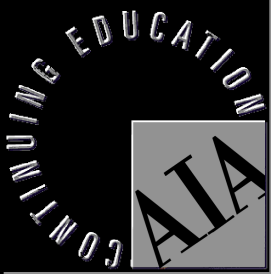

Figure 4—Wainscot Wall Detail



Maintenance of Concrete Masonry Walls

TEK 8-1A

Continuing
Education
System

Table 2 – Estimated Life of Materials

Material	Estimated Life (Years)
Concrete Masonry Units	100+
Caulking	5-15
Coping/flushing	25+
Mortar	100+
Paint	5-10
Post-applied water repellent	5-10
Stucco on masonry	100+

Determining Shadows

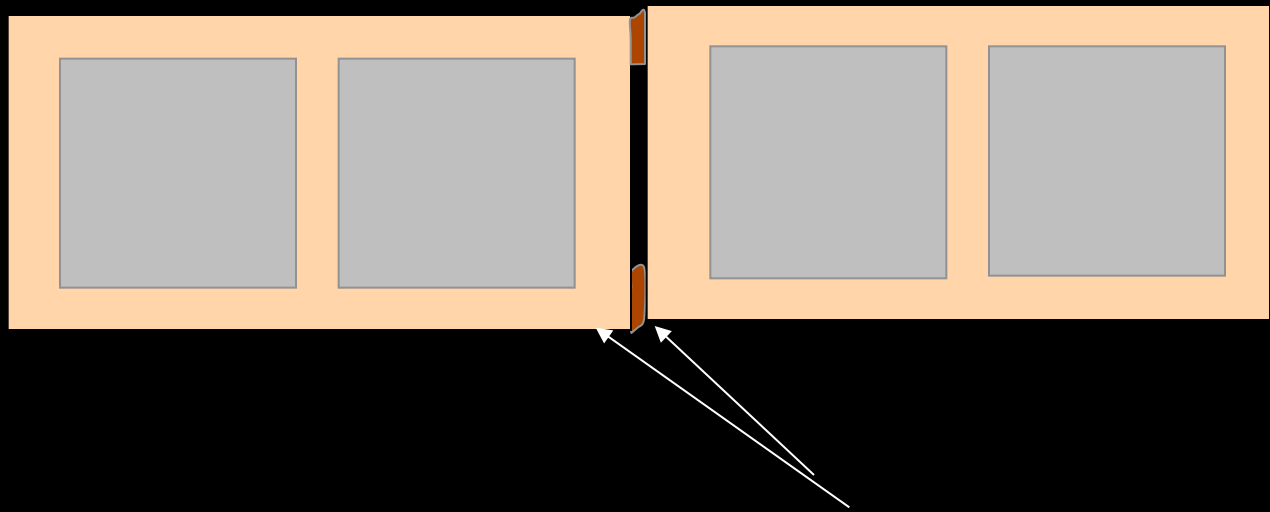

Allowable Tolerances and Offsets
from Materials, Construction,
and Combined Movements

Calculating Shadows

Continuing
Education
System

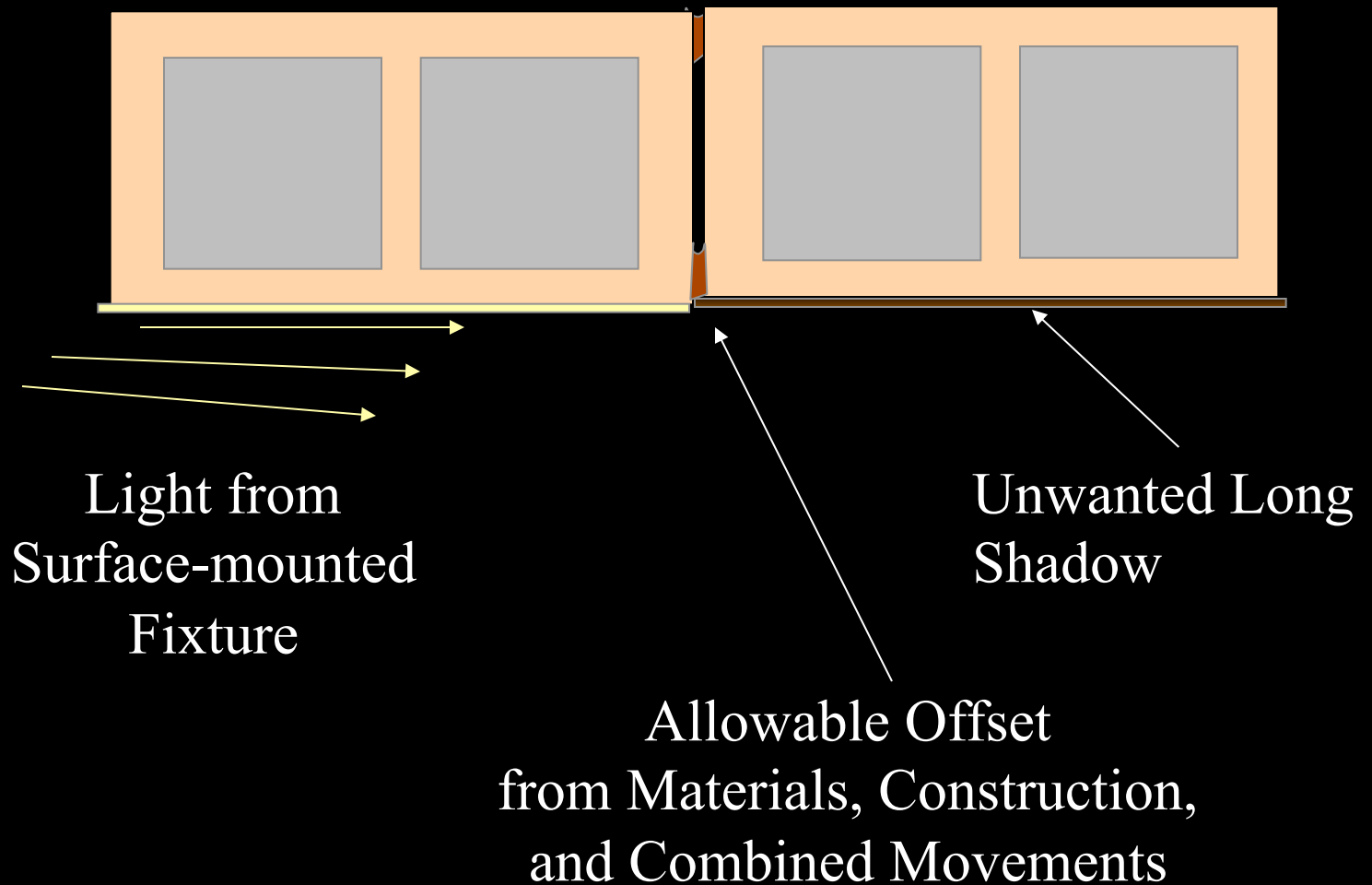

Enhancing Masonry: Controlling Shadows

Continuing
Education
System

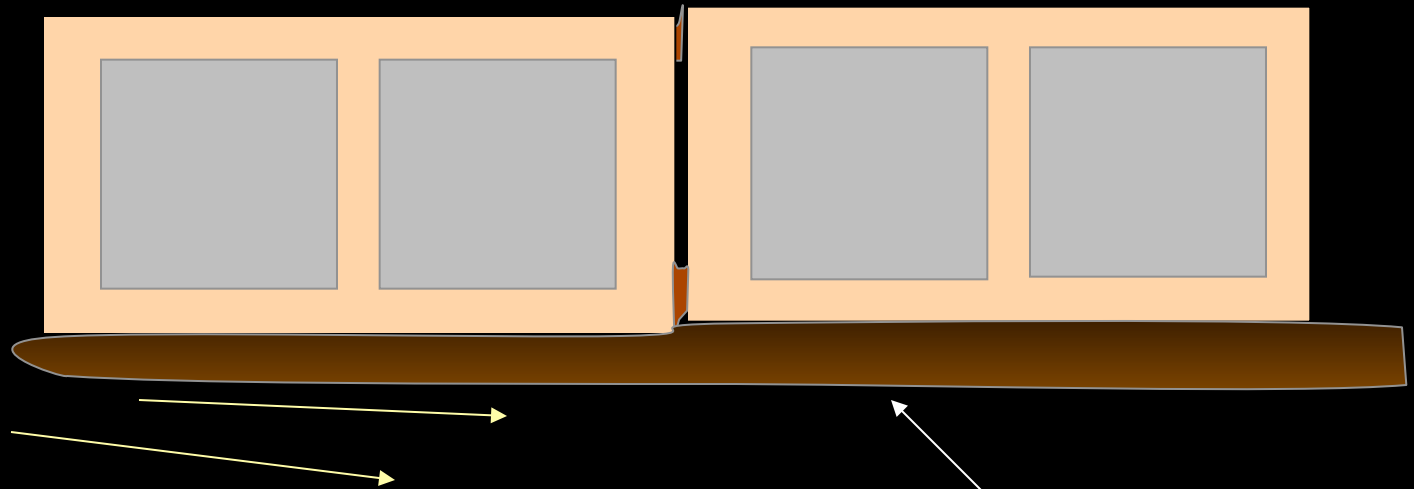

Offset, diffuse,
and/or Partially
Blocked Light
from Wall-mounted
Fixture

Low to subliminal light
= Darkened Area;
No Shadows

Enhancing Masonry: Controlling Shadows

Continuing
Education
System

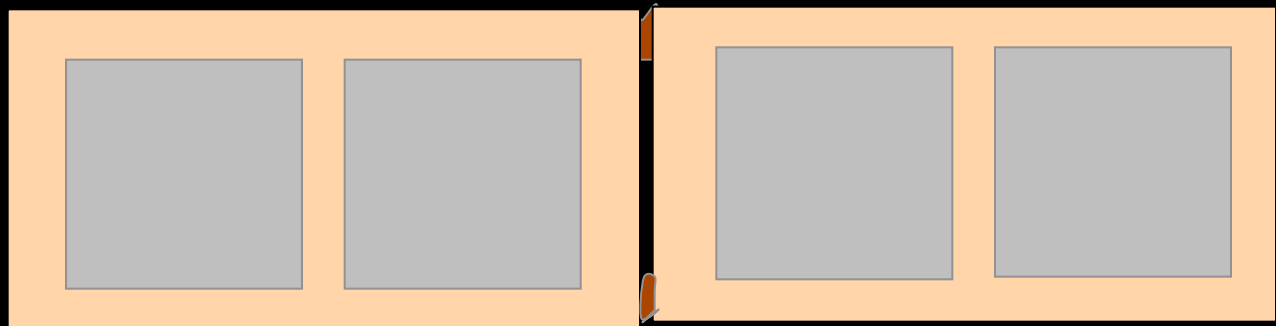

Place Shadows
into Joints

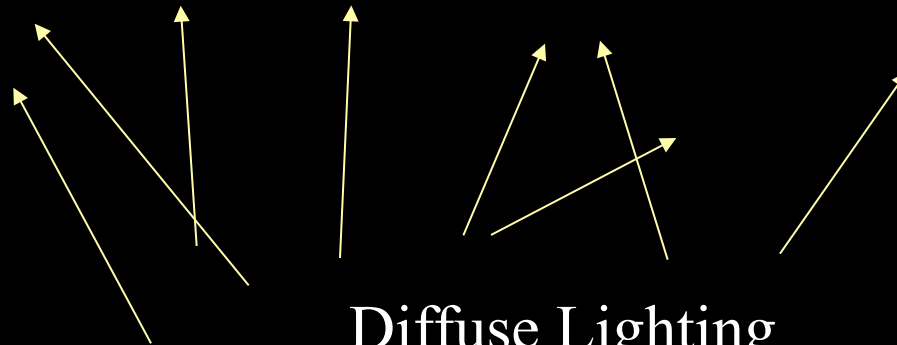

Diffuse Lighting



Summary

NCMA

Continuing
Education
System

- **Architecture can be enhanced using masonry**
 - **Proper design techniques.**
 - **In alliance with existing building codes and specifications.**
 - **To the satisfaction of the Client**
 - **Acknowledging masonry's time-honored characteristics**
 - **With an acceptable bottom line**



NCMA, Members, and Affiliates Disclaimer Notice

Continuing
Education
System

- Disclaimer: Although care has been taken to ensure the enclosed information is as accurate and complete as possible, NCMA, its Members, Affiliates, and the individuals and corporations associated with it do not assume responsibility for errors or omissions resulting from the use of this program and its contents.



References

Continuing
Education
System

- **ASTM; ASTM International, 100 Barr Harbor Drive, PO Box C700, West Conshohocken, PA, 19428-2959 USA**
- **International Building Codes and Commentary; ICC; International Code Council Inc., 4051 West Flossmoor Road, Country Club Hills, Ill, 60478-5795.**
- **MSJC; Masonry Standards Joint Committee; The Masonry Society, 3970 Broadway, Suite 201-D, Boulder, CO USA 80304-1135**
- **Steffy, Gary R., LC, IES, FIALD, Architectural Lighting Design, 2nd ed., John Wiley & Sons, 2002, N.Y., N.Y.**

Course Evaluations

In order to maintain high-quality learning experiences, please access the evaluation for this course by logging into CES Discovery and clicking on the Course Evaluation link on the left side of the page.

Continuing
Education
System

THE AMERICAN INSTITUTE OF ARCHITECTS

Discovery Home Notifications Scheduled Courses Course Directory Self-Report Activities Transcript Resources

CESDiscovery

- Update My Account
- E-mail AIA/CES Member Care Center
- Course Evaluation

Welcome, AIA Members

- Find Courses**
Search the CES Discovery for available courses.
- Events**
Check out the schedule of upcoming provider training Web seminars and events.
- MCE Requirements**
Find links to all U.S. state and Canadian licensing requirements.
- Get Started**
Need assistance? Explore our online tutorials and simulations that will guide your way through CES Discovery.

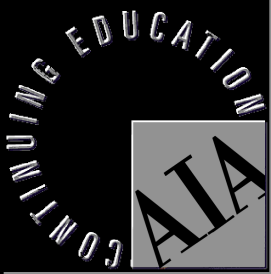

Questions??

Continuing
Education
System

Thank you for your time!

This concludes the American Institute of Architects Continuing Education Systems Course .



13750 Sunrise Valley Drive
Herndon, VA 20171
703-713-1900

e-mail: ncma@ncma.org

Web: www.ncma.org